

Harrison Ave. Sewer Main Extension & Frontage Improvements

UPCOMING ROADWAY & UTILITY CONSTRUCTION NOTICE

Dear Neighbor,

Please be advised that construction activities associated with the Harrison Avenue Sewer Main Extension and frontage improvements related to the new development will begin starting May 18, 2026, along portions of Harrison Avenue. Frontage improvements are limited to the new development frontage. Sewer utility work will extend through portions of Harrison Avenue as shown on the map below.

Residents may experience temporary traffic delays and construction-related impacts during the work.

A temporary travel lane will be constructed on the west side of Harrison Ave, and one lane of alternating traffic will be maintained at all times under flagger control. The speed limit through the work zone will be reduced to 25 MPH.

Working hours will be 7 A.M. to 6 P.M. on weekdays, excluding holidays. During portions of the sewer main installation, work will be 24 hours per day for approximately 30 days.

Local access for residents and guests will be maintained throughout the project.

Fire, EMS, Lewis County Sheriff's Office, USPS, Sanitation Services, and Wastewater Management will be allowed access at all times.

Please be cautious when walking or driving through the work area and follow flagger direction as needed.

LOCATION	IMPROVEMENTS START	SPEED	CONTROL
Harrison Ave between Sandra Ave and the Ryerson Building	May 18, 2026, Through November 2026	25 MPH	1 lane, two-way with flaggers

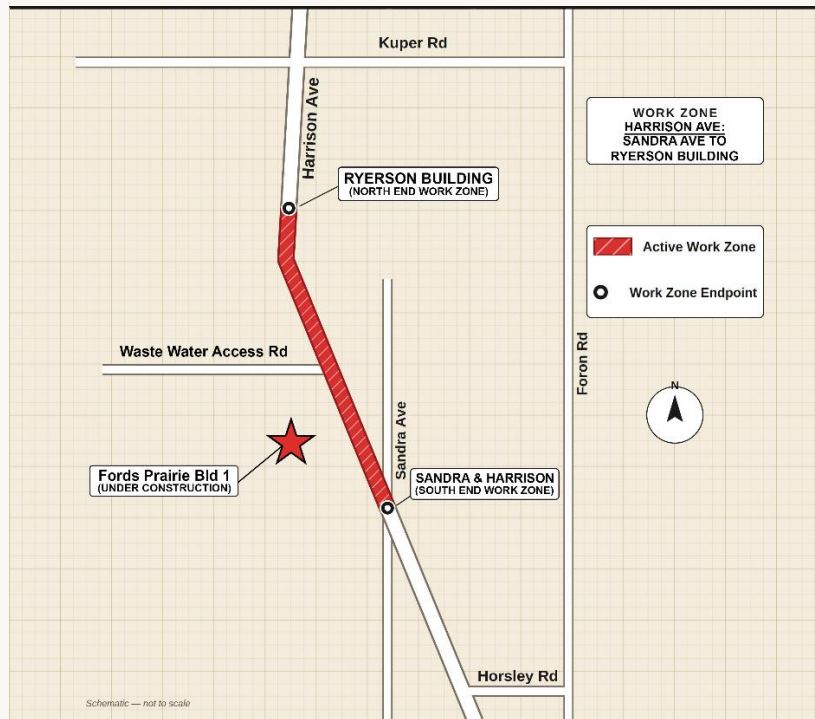

This project is being constructed in coordination with the City of Centralia and Lewis County

Delivered by Poe Construction & Miles Resources

